

CLUTCHES CAM 611

CAM 611: ROPE CLUTCH

A new model for line 6 to 11 mm, available in single, double and triple, as well as horizontal. CAM 611 has a box structure in UV-resistant resin with steel reinforcements, an extruded aluminium base, wear-resistant bronze cam mechanism, and stainless steel aligning bushing. The clutch can be completely dismantled for simple maintenance. Line retrieval can be achieved with the lever closed, and the cam mechanism guarantees easy opening even under heavy load.

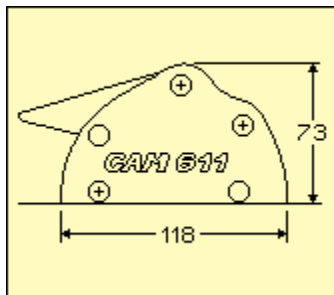
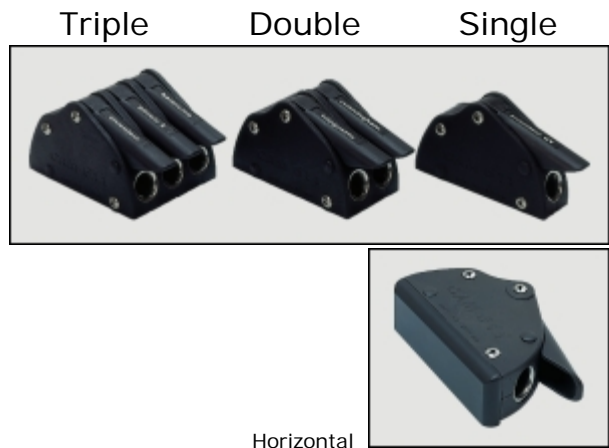

MODEL	Ø LINE mm	TYPE	WIDTH mm	WEIGHT kg	SCREWS N° x Ø mm
513.110	6 / 11	SINGLE	33	0.30	2 x Ø6
513.120		DOUBLE	62	0.60	4 x Ø6
513.130		TRIPLE	91	0.90	6 x Ø6
513.210		HORIZONTAL	33	0.30	2 x Ø6 + 1 x Ø5

