

CLEW BLOCKS

D = 70 - 225 mm



Mod. 991.073

A new solution designed to solve the connection of a sheave to the furling mainsail clew efficiently.

The block is contained within the size of the sail, thus allowing a larger surface of the sail to be used.

The choice of materials guarantees the least weight as well as a very good environmental resistance.

Particular care has been taken over the ease of connection which is obtained by normal "webbing".

This ensures moreover a very good distribution of the load on the sail.

MATERIALS: Cheek plates are made of anodised aluminium. Polished s/steel solutions are available on request..

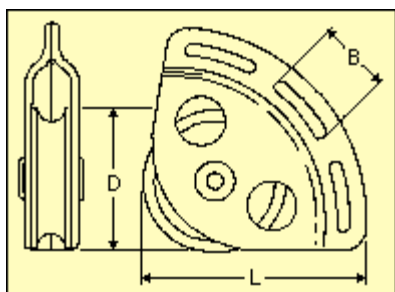

| MODEL | Ø LINE mm | D mm | L mm | B mm | W kg | R kg | WEIGHT kg |
|---------|-----------|------|------|--------|------|-------|-----------|
| 991.073 | 14 | 70 | 112 | 3 x 36 | 1000 | 2000 | 0.25 |
| 991.093 | 16 | 90 | 145 | 3 x 46 | 2000 | 4000 | 0.46 |
| 991.124 | 18 | 120 | 190 | 4 x 46 | 3000 | 6000 | 1.05 |
| 991.154 | 20 | 150 | 225 | 4 x 52 | 4000 | 8000 | 2.05 |
| 991.184 | 24 | 180 | 265 | 5 x 52 | 8000 | 16000 | 2.65 |

W **R**
WORKING LOAD BREAKING STRENGTH



Maxi Clew block: s. steel cheek plates and alu sheave $D = 230$ mm tested for a breaking load higher than 30 ton.



**BUREAU
VERITAS**